

# TOWNSHIP N°27 NORTH, RANGE N°40 EAST OF THE MOUNT DIABLO MERIDIAN, NEVADA.

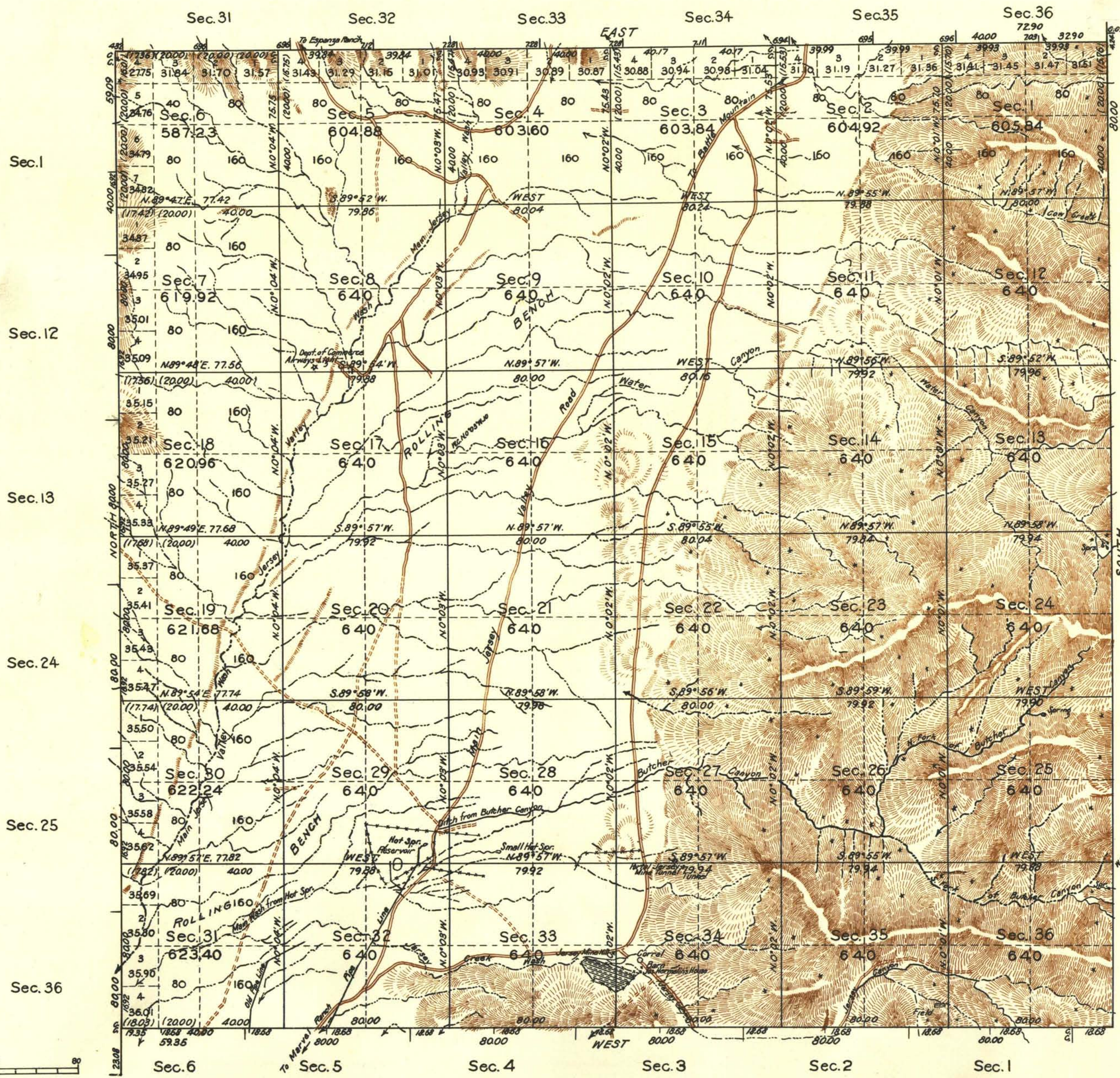

Note—  
U.S. Engineer reports considerable prospecting in Sec. 34 with small shipments of silver and lead ore and indications of Mineral in W. 1/2 of this section.

Latitude 40°10' N.  
Longitude 117°25' W.

Scale 40 Chains to an Inch.

Area Surveyed 22,718.51 Acres.

LINES DESIGNATED	BY WHOM SURVEYED	GROUP		MILEAGE		WHEN SURVEYED	
		NO.	DATE	MLS.	CHS.	BEGUN	COMPLETED
N.S. & W. Boundaries	George W. Ridgway	152	Sept. 17, 1928.	18	14.34	June 25, 1929.	Aug. 22, 1929.
Subdivisions	" " "	"	" " "	59	45.12	July 8, 1921.	Aug. 21, 1929.
East Boundary	H.W. Reppert & W.R. Johnston	36	May 17, 1915.			June 11, 1915.	June 16, 1915.
North "	E. Voigt & W. H. Good	72	Feb. 27, 1919.			May 11, 1921.	July 18, 1921.
South "	George W. Ridgway	113	Sept. 22, 1923.			Oct. 20, 1928.	Oct. 23, 1928.

Office of U.S. Supervisor of Surveys  
Denver, Colorado Aug. 22, 1931  
The above plat of Township No. 27 North, Range No. 40 East of the Mount Diablo Meridian Nevada, is strictly conformable to the field notes of the survey thereof which have been examined and approved.

*Wm. H. Johnson*  
U.S. Supervisor of Surveys.

DEPARTMENT OF THE INTERIOR  
GENERAL LAND OFFICE  
Washington, D.C. January 14, 1932  
The survey represented by this plat having been correctly executed in accordance with the requirements of law and the regulations of this office is hereby accepted.

*Wm. C. Howell*  
Assistant Commissioner.